

Neata[®]

+ Super energy

Deep Cycle Long Life series

Datasheet : NTD12-250 (12V250AH)

Nominal Voltage	12V
Number of cell	6
Design Life	12 years
Nominal Capacity 77°F(25°C)	
10 hour rate (8.75A, 10.5V)	250Ah
5hour rate (16.2A, 10.5V)	217.5Ah
3 hour rate (29.8A, 10.5V)	198.9Ah
1 hour rate (112.0A, 9.6V)	160Ah
Internal Resistance	
Fully Charged battery 77°F(25°C)	≤3.0mOhms
Self-Discharge	
3% of capacity declined per month at 20°C(average)	
Operating Temperature Range	
Discharge	-20~60°C
Charge	-10~60°C
Storage	-20~60°C
Max. Discharge Current 77°F(25°C)	1250(5s)
Short Circuit Current	4300A
Charge Methods: Constant Voltage Charge 77°F(25°C)	
Cycle use	2.40-2.45VPC
Maximum charging current	75A
Temperature compensation	-30mV/°C
Standby use	13.6-13.8V
Temperature compensation	-20mV/°C



Wide Range Temperature



Warranty



Maintenance Free



Deep cycle Technology



easy use



long life

Mechanical Characteristics

Length(mm / inch)	520 / 20.5
Width(mm / inch)	269 / 10.6
Height(mm / inch)	221 / 8.0
Total Height(mm / inch)	227 / 8.2
Approx. Weight(Kg / lbs)	69.0 / 151.8

* Weight deviation: ± 3%

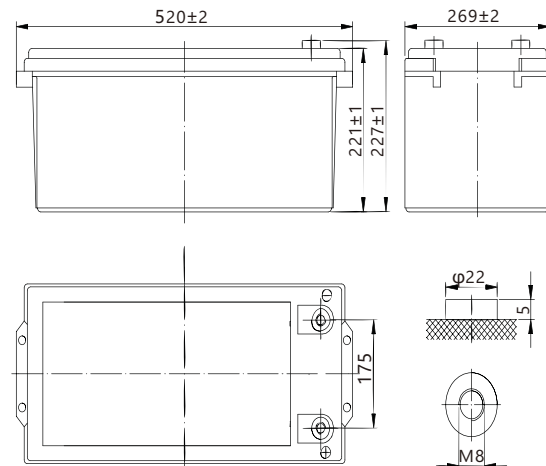

Technical Characteristics

Discharge Constant Current (Amperes at 77°F25°C)

End Point	Volts/Cell	10min	15min	30min	45min	1h	3h	5h	10h
1.60V	--	463	274	195	160	72.3	47.2	25.6	
1.65V	--	430	258	186	153	69.5	45.5	25.4	
1.70V	--	415	252	182	150	68.3	44.8	25.3	
1.75V	--	386	240	178	146	66.3	43.5	25.2	
1.80V	--	357	229	176	142	64.2	42.5	25.0	

Discharge Constant Power (Watts at 77°F25°C)

End Point	Volts/Cell	10min	15min	30min	45min	1h	2h	3h	5h
1.60V	--	810	497	361	300	182	135	91.0	
1.65V	--	770	475	347	291	175	133	88.2	
1.70V	--	747	465	343	285	172	131	87.0	
1.75V	--	705	449	332	278	165	127	85.2	
1.80V	--	660	434	325	268	160	123	83.2	

(Note)The above characteristics data are average values obtained within three charge/discharge cycles. All data shall be changed without notice, Neata reserves the right to explain and update the information.

SHENZHEN OFFICE (CHINA)
Tel: +86-755-2691-9474
Fax: +86-755-2691-9474

Recognized under CE/ IEC and certified by ISO9001 ,14001



Neata[®] //Shenzhen Neata Power Tech co.,Ltd//www.neata-batt.com

Neata[®] Deep Cycle Long Life series

Datasheet : NTD12-250 (12V250AH)

Discharge Characteristics Curve

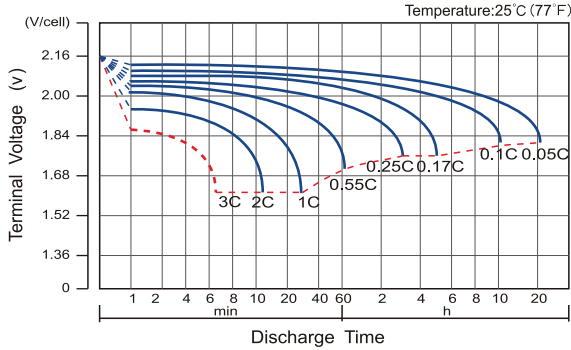

Charge Characteristic Curve For Standby Use

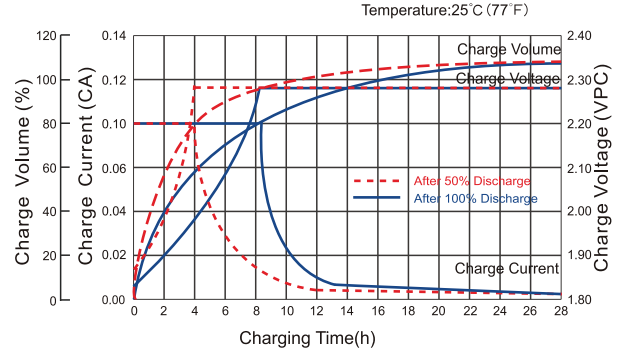

Cycle Life In Relation To Depth Of Discharge

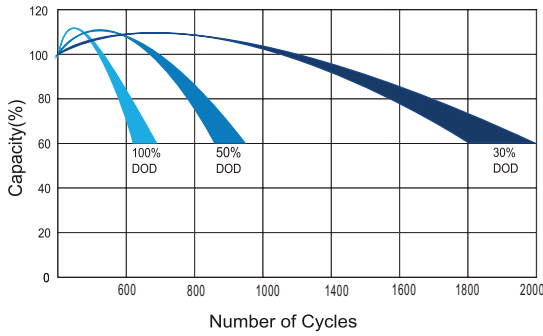

Temperature Effects On Capacity

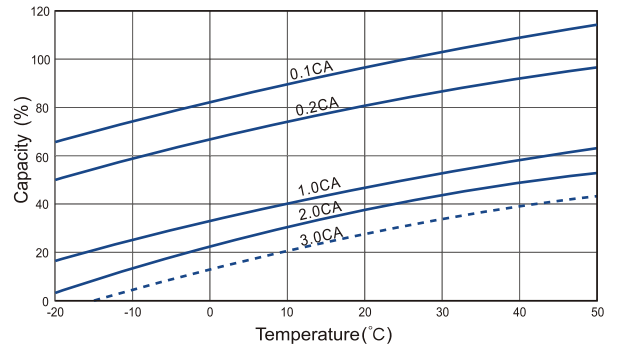

Relationship Between Charging Voltage And Temperature

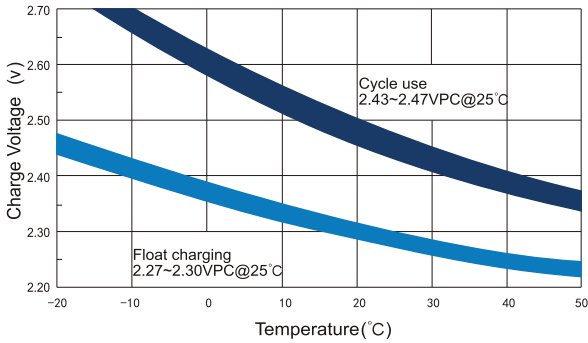

Storage Characteristics

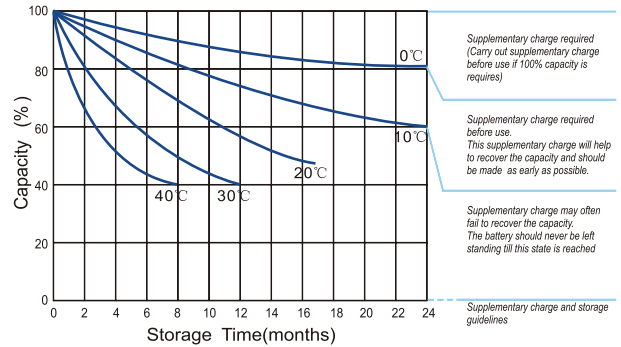

Effect Of Temperature On Long Term Life

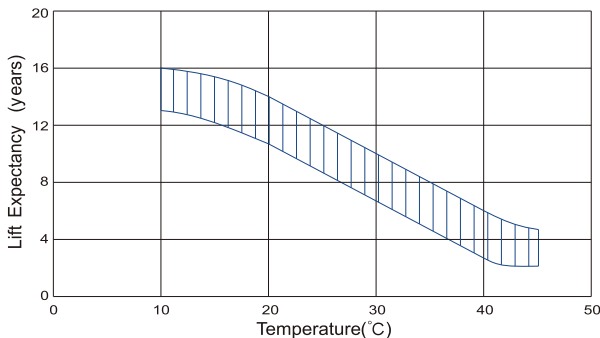

Life Characteristics Of Standby Use

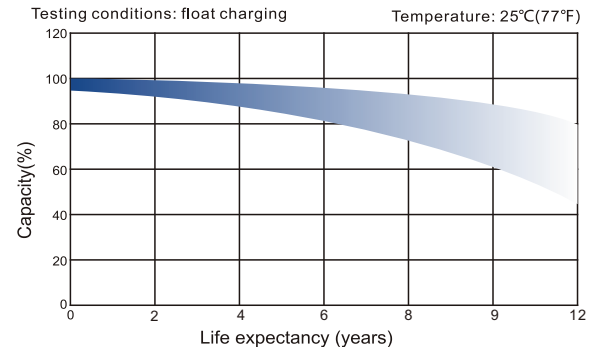

SHENZHEN OFFICE (CHINA)
Tel: +86-755-2691-9474
Fax: +86-755-2691-9474

Recognized under CE/IEC and certified by ISO9001,14001

